

Tree Retention Report prepared for; Mr. and Mrs. Laustrup

Updated March 22nd, 2022



Prepared by: Outlook Arborist Services BL #176975

John Monk

ISA Arborist PN0401

Qualified Tree Risk Assessor

ITA Practical Horticulturalist

ITA Utility Arborist

jmonktrees@gmail.com

604-816-2592

March 5th, 2022

Introduction:

Mr. Dave Laustrup and his family are planning to develop this property in Pitt Meadows to accommodate their family.

This property is level and at the end of a cul-de-sac in an established neighborhood east of the airport in Pitt Meadows. Existing on this property is a rancher that is planned to be removed and two new family homes built.

The purpose of my site visit with Mr. Laustrup is to determine how close ground disturbance for digging or driveways can be from mature Cedar hedges.

The following are my observations and recommendations.

Observations;

On the north side of the property separating the frontage of 11600 is a mature row of Hedge Conifers called pyramidalis Cedars. Their botanical name is *Thuja plicata pyramidalis* and they are very commonly planted for tall narrow hedges. Suitable for privacy, they are mutually beneficial to both sides where a fence is either impractical or not needed.

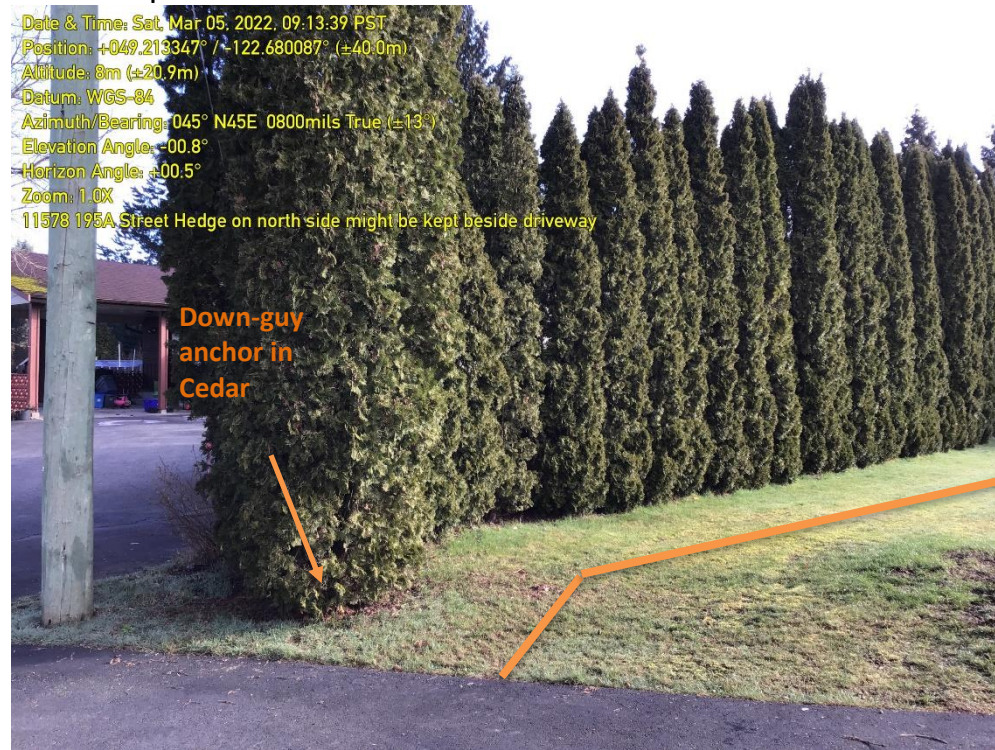

From the existing driveway, keep a minimum of 1 meter from the drip line of the foliage on these Cedars

First Cedar hides a pole down-guy anchor inside.

Outlook Arborist Services

This row on the north side are in fair condition. A driveway may be planned along this side to a new home. Ideally, digging topsoil 1 meter from the edge of the foliage should be planned to retain these Cedars. Work done during the summer is more stressful and watering will be required if its done during dry periods of the year. *Should any Cedars need removing for driveway placement, leave the stumps in the ground within 1 meter of the adjacent tree. Light trimming of the new edge tree will recover within one to two years and fill in lost foliage.*



Same north hedge untrimmed, natural and in fair condition. Do not top or shear, Cedars are less likely to suffer snow spreading if un-topped.

The second location with Hedge Cedars is along the east end of the front yard.

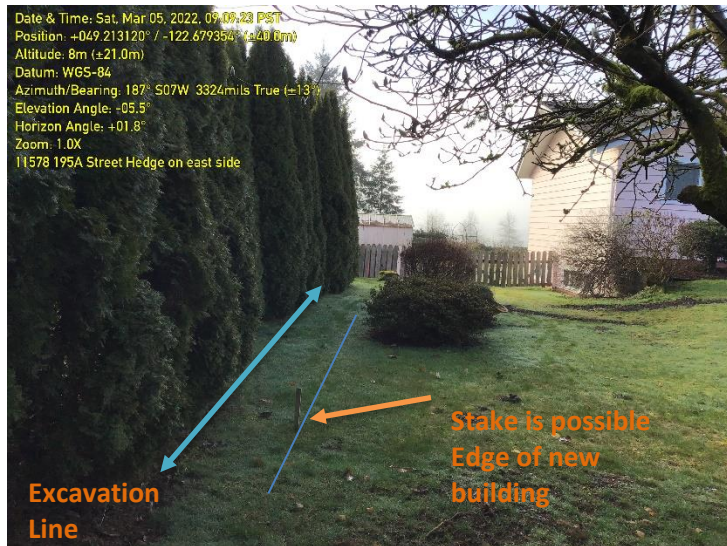

The Pyramidalis Cedar Hedge along the east side fronts a fence. These Cedars are very likely to be disturbed for footing excavation well outside the line of the finished foundation. Approximately 1 meter outside for footing framing and perimeter drainage and gravel will be very close to these trees. They do provide some privacy taller than a fence but may decline if root loss is excessive. Certainly they can attempt to be retained but will be very close to the new home. Should the decision to retain these trees be the outcome, ensures summer irrigation and backfill with suitable soil, not clay.

Sincerely,

John Monk
ISA Arborist PN0401
Tree Risk Assessor # 10685
ITA Utility Arborist